

A map dating from 1615 shows land in the parish of Michelmersh that was owned by Corpus Christi College in Oxford. One section of the map depicts the Test from Timsbury bridge to Greatbridge. The more southerly bridge is the smaller of the two. The leat to Greatbridge mill had not yet been built, so only a single channel needed to be crossed at this point. The Fishlake flows out of the Test on its way to Romsey. Four fields adjacent to it are located in Fishlette Meade, now part of Fishlake Meadows nature reserve. The fields are labelled with the names of their owners. George Churcher owned the northernmost of the fields and appears to have owned a building adjacent to the Fishlake. The field to the south belonged to Mr Apleforde, and then a narrow strip is labelled 'R(?) Wellinor cop.'. The next strip of land belonging to Corpus Christi College measured 0.3.14 acre-rood-perch or 0.8375 acres. Also noted is 'Douse' who is named on several other fields on the map as the tenant Thomas Douse.

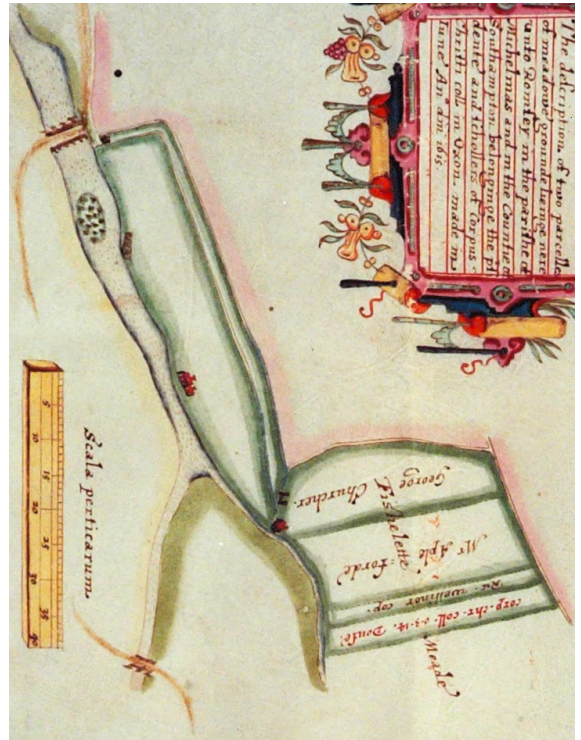

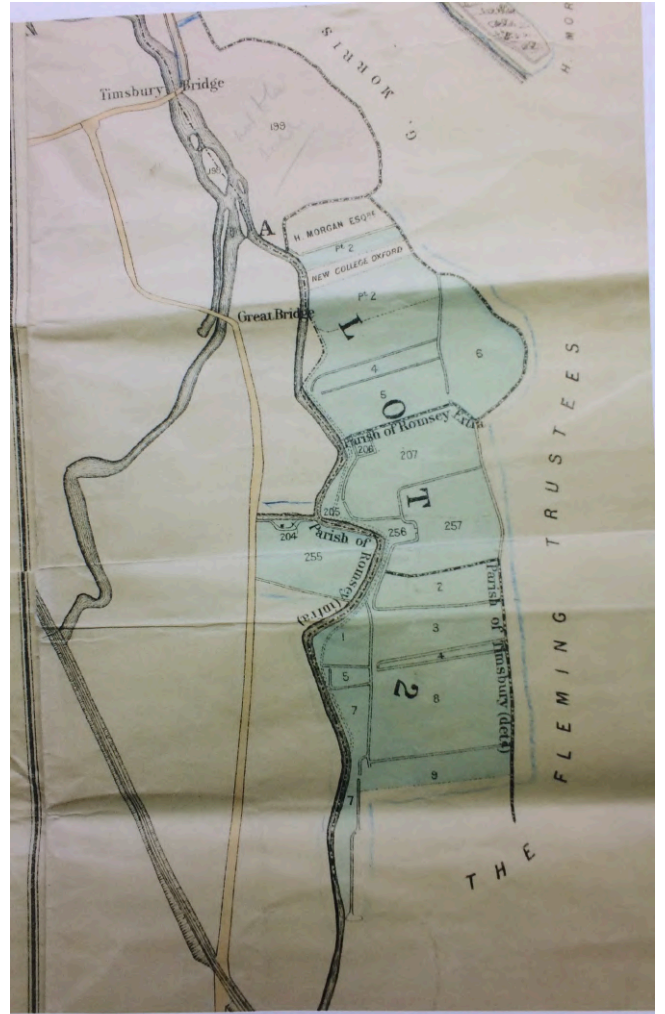

Based on earlier map. 1938 SALE

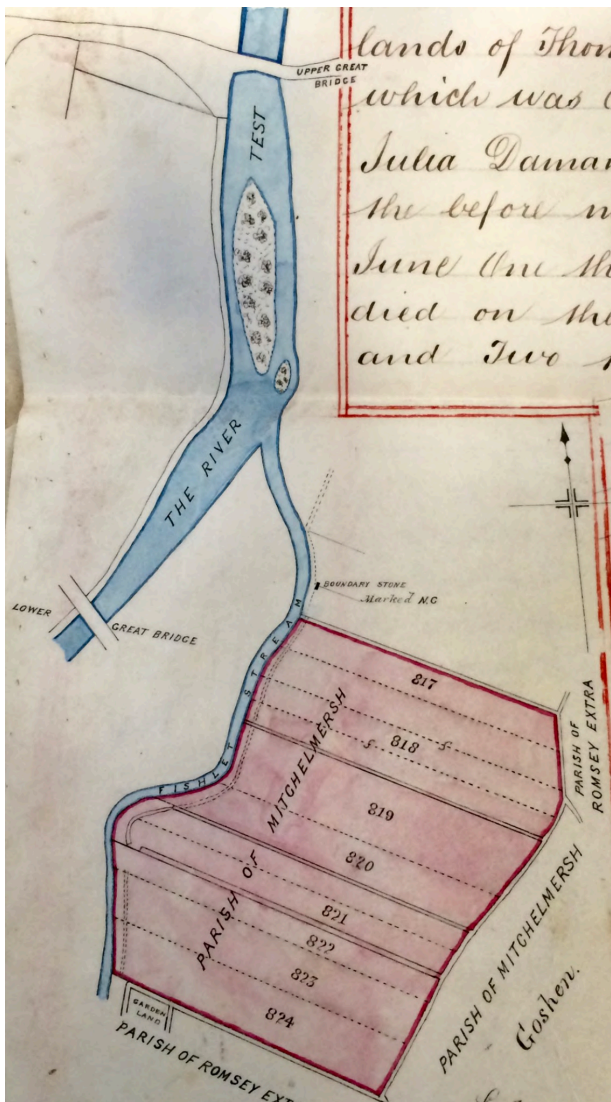



The strip of Michelmersh land running west from the barge canal provides the only crossing point for Fishlake Meadows. The path has been upgraded since the creation of the nature reserve.

Michelmersh tithe map:

Heathcote Thomas	Clarke John William	815	A Field	Pasture
Goffe William	Jones Catherine	816	A Field	Pasture
New College Oxford and John Wade the representative of the late Mary Eldefield, the lessee contd	Jones Catherine	816.1	A Field	Pasture
Daman William Charles	Jones Catherine	817	A Field	Pasture
Daman William Charles	Jones Catherine	818	A Field	Pasture
Daman William Charles	Jones Catherine	819	A Field	Pasture
Daman William Charles	Jones Catherine	820	A Field	Pasture
Daman William Charles	Jones Catherine	821	A Field	Pasture
Daman William Charles	Jones Catherine	822	A Field	Pasture
Daman William Charles	Jones Catherine	823	A Field	Pasture
Daman William Charles	Jones Catherine	824	A Field	Pasture
Sherborne The Right Hon John Lord	Jones Catherine	825	Goshen	Pasture
Heathcote Thomas	Clarke John William	826	A Field	Pasture

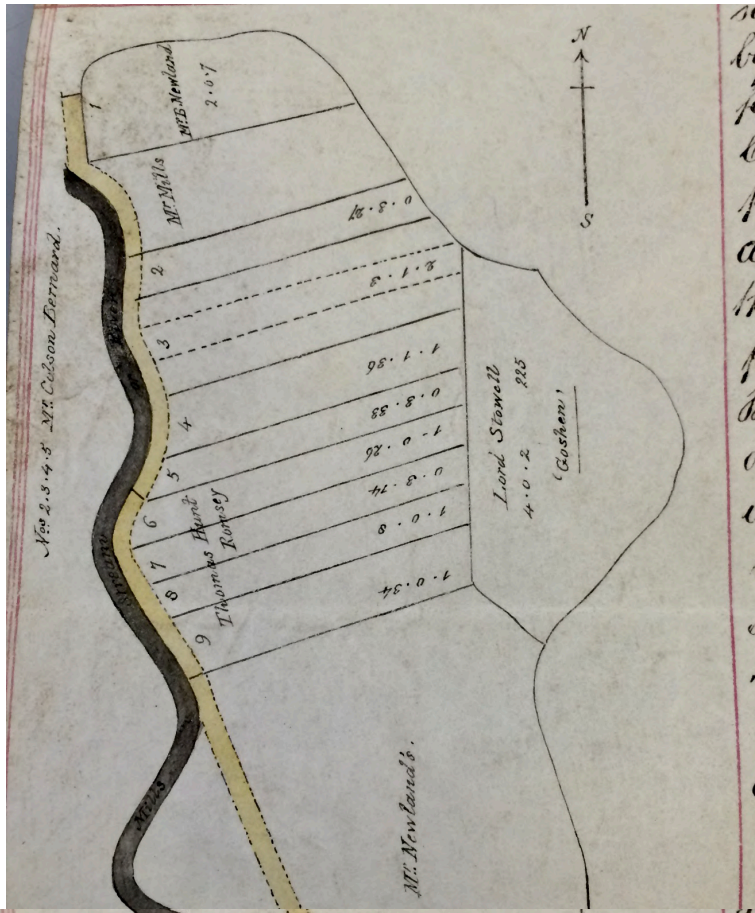

'Goshen' lies along the east side of the path leading to the hides.

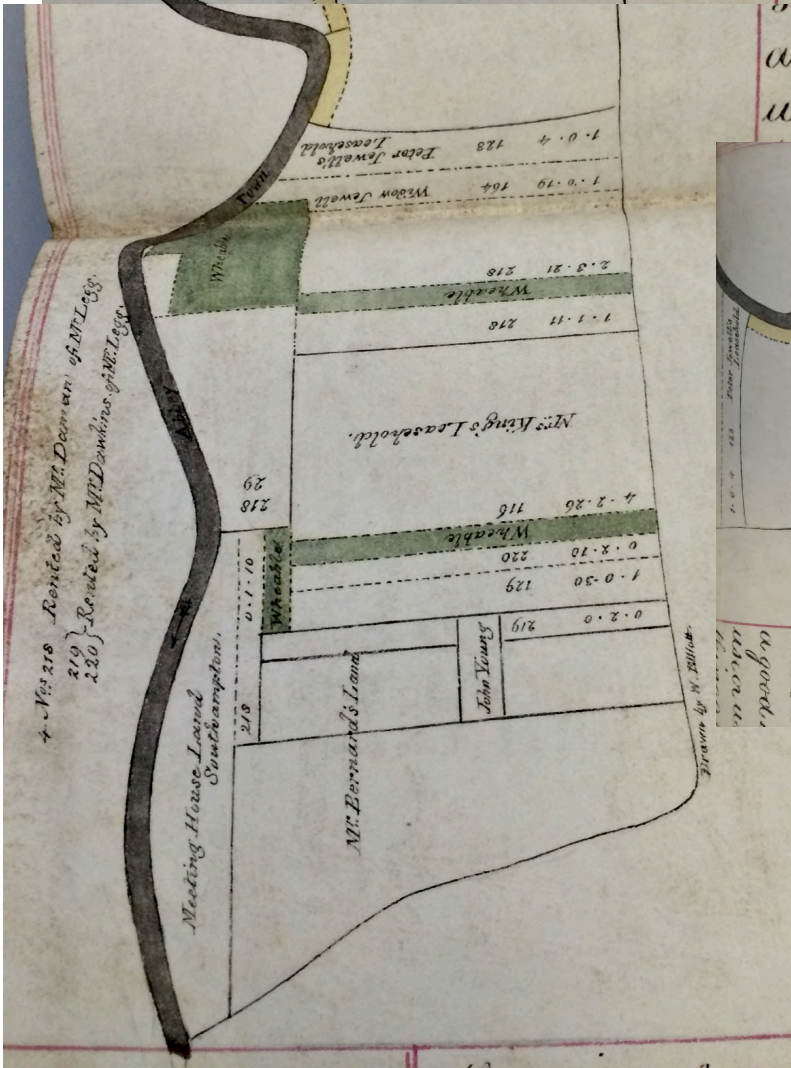

1833 map.

Tintwistle Ch, a barrow *Adam's Grave* Alton Priors W, a stone *Adam's Seat* next to Sadgill Cu.¹⁷

Another quality that underlies a number of place-names is (in)fertility of the land and the effort required to till it, as assessed by the users. Field's work contains many examples of these (Field 1993; EFND). Complimentary names are few: *Canaan* Worth Matravers Do, *Land of Promise* Mx ('land flowing with milk and honey', an allusion to Exo. 3:8), *Paradise* in many counties, e.g. *Paradyse* 1380 Carlisle Cu, *Paradise* Appleton Ch, *Goshan* Odd Rode Ch and *Goshen* Uphall W Loth ('the best of the land' for cattle-breeding in Egypt, an allusion to Gen. 45–7, where Joseph's kin settled after fleeing the famine in Canaan, also later, the area untouched by the Egyptian plagues, 'a common XVIII–XIX century farm-name' standing for 'land of plenty' and 'land without plagues', see Hough 2001: 41)).¹⁸ Uncomplimentary names are more common and include names referring to:

(a) places, such as the field-names *Gomorrah* Close Snaith WRY and *Sodom* Field Brampton Db, alluding to the Dead Sea and barren

EPNS Vol 42, 2010,

Vladislav Alpatov, Place-names with Christian Associations, p 23

Timsbury tithe map:

Sherborne Rt Hon Lord John	Caroline Jones	221	A Field	Meadow
Sherborne Rt Hon Lord John	Caroline Jones	222	A Field	Meadow
Sherborne Rt Hon Lord John	Caroline Jones	223	A Field	Pasture
Clark John	Clark John	224	A Field	Pasture & Osiers
Clark John	Clark John	225	A Field	Pasture & Osiers
Sherborne Rt Hon Lord John	Caroline Jones	226	A Field	Pasture
Sherborne Rt Hon Lord John	Caroline Jones	227	A Field	Pasture
Sherborne Rt Hon Lord John	Caroline Jones	228	A Field	Pasture
Clark John	Clark John	229	A Field	Osiers
Sherborne Rt Hon Lord John	Caroline Jones	230	A Field	Pasture
Sherborne Rt Hon Lord John	Caroline Jones	231	A Field	Pasture
Sherborne Rt Hon Lord John	Caroline Jones	232	A Field	Pasture
Smith John	Smith John	233	A Field	
Damon W C	Caroline Jones	234	A Field	Pasture
Soffe W. & Young J.	John Smith	235	A Field	Pasture

Romsey tithe map:

John Willis Fleming	Thomas Fryer	1117	Fishlake Meadow	Meadow
John Willis Fleming	Charles Feltham	1118	Fishlake Meadow	Meadow
James Smith	James Smith	1119	Fishlake Meadow	Meadow & Pasture
John Willis Fleming	John Bennett	1120	Upper Fishlake Meadow	Meadow
John Willis Fleming	John Bennett	1121	Middle Fishlake Meadow	Meadow
John Willis Fleming	John Bennett	1122	Lower Fishlake Meadow	Meadow
John Willis Fleming	John Gear	1123	Upper Fishlake Meadow	Meadow
John Willis Fleming	John Gear	1124	Lower Fishlake Meadow	Meadow